

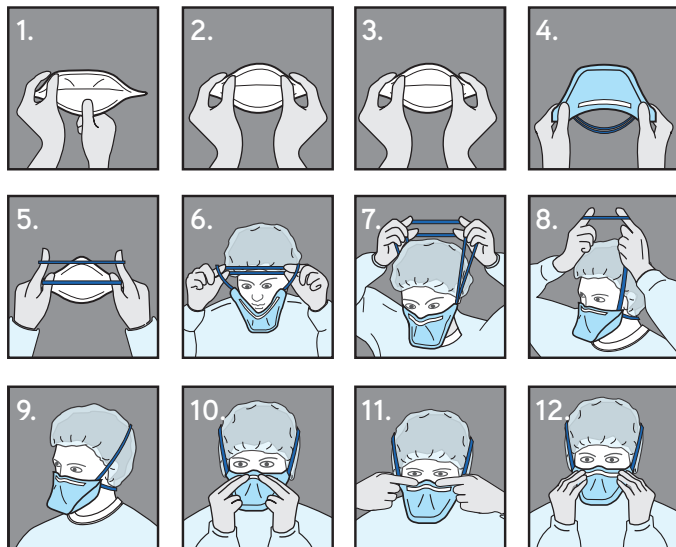

DONNING INSTRUCTIONS



1. Separate the edges of the respirator to open fully.
2. Slightly bend the nosepiece to form a curve.
3. Use your index fingers and thumbs to form a tighter curve at the center of the nosepiece.
4. Hold the respirator upside down to reveal the two headbands.
5. Separate the two headbands with your index fingers and thumbs.
6. Cup the respirator under your chin while holding both headbands with your index fingers and thumbs.
7. Pull both headbands over your head.
8. Position and release the lower headband at the base of your neck.
9. Position and release the top headband on the crown of your head.
10. Conform the nosepiece to your nose by firmly pressing down with your fingers.
11. Continue to adjust the respirator edges until you have achieved a secure fit.
12. Perform negative pressure user seal check. Respirator user inhales sharply while blocking the paths for air to enter the facepiece. A successful check is when the facepiece collapses slightly under the negative pressure created with this procedure.



Advanced Concept Innovations, LLC
4100 Frontage Road S., Lakeland, FL 33815
863.688.1200
inquiries@ACIN95.com



This respirator is approved only in the following configuration:

TC-	Protection ¹	Respirator	Cautions and Limitations ²
84A-9318	Surgical/N95	3120	ABCJMNOS
		X	

1. PROTECTION:

N95 - Particulate Filter (95% filter efficiency level).
Effective against particulate aerosols free of oil; time use restrictions may apply

2. CAUTIONS AND LIMITATIONS:

- A. Not for use in atmospheres containing less than 19.5 % oxygen.
- B. Not for use in atmospheres immediately dangerous to life or health.
- C. Do not exceed maximum use concentrations established by regulatory standards.
- J. Failure to properly use and maintain this product could result in injury or death.
- M. All approved respirators shall be selected, fitted, used, and maintained in accordance with MSHA, OSHA, and other applicable regulations.
- N. Never substitute, modify, add, or omit parts. Use only replacement parts in the configuration as specified by the manufacturer.
- O. Refer to users instructions, and/or maintenance manuals for information on use and maintenance of these respirators.
- S. Special or critical User Instructions and/or specific use limitations apply. Refer to User Instructions before donning.

S- Special or Critical User Instructions

This respirator has been approved as a NIOSH N95 filtering facepiece respirator, for use in healthcare settings, as a Surgical N95 Respirator conforming to recognized standards for biocompatibility, flammability, and fluid resistance.

Before occupational use of this respirator, a written respiratory protection program must be implemented meeting all the local government requirements. In the United States, employers must comply with OSHA 29 CFR 1910.134 which includes medical evaluation, training, and fit testing.



CHECK PRIOR TO USE

- Check for any visible damage.
- Check expiration date.
- Damaged or soiled particle filtering half masks or particle filtering half masks where the expiration date has elapsed must not be used.

FITTING INSTRUCTIONS

- Nosepiece side up / Labeling facing down.
- Follow Directions For Application each time respirator is worn.
- Check facial seal to assure proper fit before entering any contaminated area.
 - Adjust nosepiece if there is air leakage around the nose.
 - Reposition headbands to secure facial seal around edges of respirator.
- Do not enter a contaminated area if a proper fit cannot be obtained. Follow all instructions and warnings on the use of this respirator, obtain a proper fit, and wear during all times of exposure. Failure to do so will reduce respirator effectiveness and user protection, and may result in sickness or death.

Advanced Concept Innovations Surgical N95 Respirator (3120) is approved and cleared for use in Healthcare Settings under the FDA/NIOSH MOU 225-18-006. This Surgical N95 provides protection against particulates at the N95 filter efficiency level of 0.3 micron particles and conforms to recognized standards for Flammability, Fluid Resistance, and Biocompatibility.

INTENDED USE

Advanced Concept Innovations Surgical N95 Respirator (3120) is intended for use in Healthcare Settings against particulate aerosols free of oil; time use restrictions may apply.

USE INSTRUCTIONS

1. Before use, the wearer must be trained by the employer in proper respirator use in accordance with applicable safety and health standards for the contaminant and exposure level in the assigned area.
2. If the respirator becomes damaged or breathing becomes difficult, leave the area. Discard and replace the respirator.







⚠ WARNING: Before occupational use of this respirator, a written respiratory protection program must be implemented meeting all the local government requirements. In the United States, employers must comply with OSHA 29 CFR 1910.134 which includes medical evaluation, training, and fit testing. Important: Follow all instruction and warnings on the use of this respirator. Wear during all times of exposure. Failure to do so will reduce respirator effectiveness and user protection, and may result in sickness or death.

TIME USE LIMITATIONS: If respirator becomes damaged, soiled, or breathing becomes difficult, leave the contaminated area and properly dispose of respirator.

⚠ WARNING: 1. Do not wear this respirator when conditions prevent a good facial seal. Reminder: It is important to fit check the respirator each time it is worn. 2. Never alter or modify this product.

CONTRAINDICATIONS

- Recommended for use in Healthcare Settings.
- Not to be used in areas with open flames.
- National regulations must be observed, e.g. BGR 190 (formerly ZH1/701) – Rules for the application and use of respirators; BGI 504-26 (formerly ZH11600.26) – Selection criteria for use in occupational medicine according to the rules of trade association, G26 “respiratory protective devices”.
- The user must be familiar with the use and handling of the device.
- Type and concentration of the hazardous substances must be known.
- Particle filtering half masks do not offer protection against gases and vapors. The mask must be replaced when high airway resistance is noticeable.
- The mask should only be used for maximum one working shift.
- Respiratory protective devices must be selected according to the type and concentration of the hazardous substance.
- Respiratory protective devices are not suitable for persons with beards, sideburns or deep scars in the area of the sealing lines of the facepieces.
- In the event of an oxygen deficiency, harmful concentrations of hazardous substances or unknown conditions, self-contained closed-circuit compressed oxygen breathing apparatus must be used independent of the environment.

 Single Use Only	 Consult Instructions for Use
 Caution	 Keep Dry and Under 60% Humidity
 Upper and Lower Temperature Limit	 Keep Away from Sunlight and Radioactivity

Distributed by:
Safety Emporium
 PO Box 1003
 Blackwood, NJ 08012
 Ph: (866) 326-5412 toll-free
 Fax: (856) 553-6154
esupport@safetyemporium.com
www.safetyemporium.com



Advanced Concept Innovations, LLC

4100 Frontage Road S.
 Lakeland, FL 33815
 863.688.1200 Ext. 7411
Inquiries@ACIN95.com
ACIN95.com

