

## INSTALLATION INSTRUCTIONS FOR TRIMLESS IN DRYWALL: TRIMLESS CABINETS

1. **NOTE that the new trimless cabinet for drywall is To be installed OVER the drywall.**
2. Remove all hardware and glazing, unlock cabinet if lock provided.
3. Install a framed opening above, below and at both sides of cabinet opening at specified location. Wall opening width, height and depth must correspond with dimensions indicated in catalog or detail and submittal sheet.
4. Use holes provided in cabinet tub for attaching to stud or substrate material. If wall configuration does not allow for that, then follow step 5 below; otherwise, skip to step 6.
5. [Drilling Additional Holes in Tub] Drill (2) 1/8" (3.2 mm) holes through tub on each side of cabinet.
6. *Valve & Hose Cabinets Only:* Select knockout location that supply pipe will enter the cabinet through. Remove knockout tab at that location and install collar. Mark location on wall and studs. Plumb to the cabinet.
7. Place cabinet in position so that the drywall flange rests flush on the drywall. Secure the face of the flange to the drywall using screws. To minimize mudding needed the flange should be as flat as possible.
8. Attach the tub to the studs with Universal # 6 x 2-1/2" (6.4 cm) self-drilling screws. Be sure not to over-tighten on either side, which could pull the cabinet out of position in the opening and result in an exposed gap between the cabinet frame and wall opening.
9. Start the screw without completely tightening; then start a screw on the opposite side of the tub. Once all screws are started, tighten each screw in a "criss-cross" pattern. A torque setting of 4-6 is recommended if using a screw gun.
10. Once screws are fully tightened, check cabinet for square and plumb. Adjust if necessary. All interior sides should be straight with no bowing or warping.
11. Check cabinet door assembly for freedom of movement. If it binds, shim as necessary to remove any racking of tub at attachments of stud. Cabinet will need to be removed temporarily in order to add shims.
12. Apply drywall mud to the wall, being sure to completely cover the flange. Take care not to get drywall mud on the hinge barrel—remove with a soft rag if needed. Apply a second coat of drywall mud if necessary, and sand to a smooth finish. Apply primer and paint.
13. Remove protective plastic from acrylic or glass and install decal if intended for glass. (Panorama Models Glazing is Pre-Installed)
14. Align glazing on inside of door, holding in place while installing glass mounting clips on inside of door. Do not over-tighten.
15. Install handle and roller catch or SAF-T-LOK™ in door. Install alarm if provided.

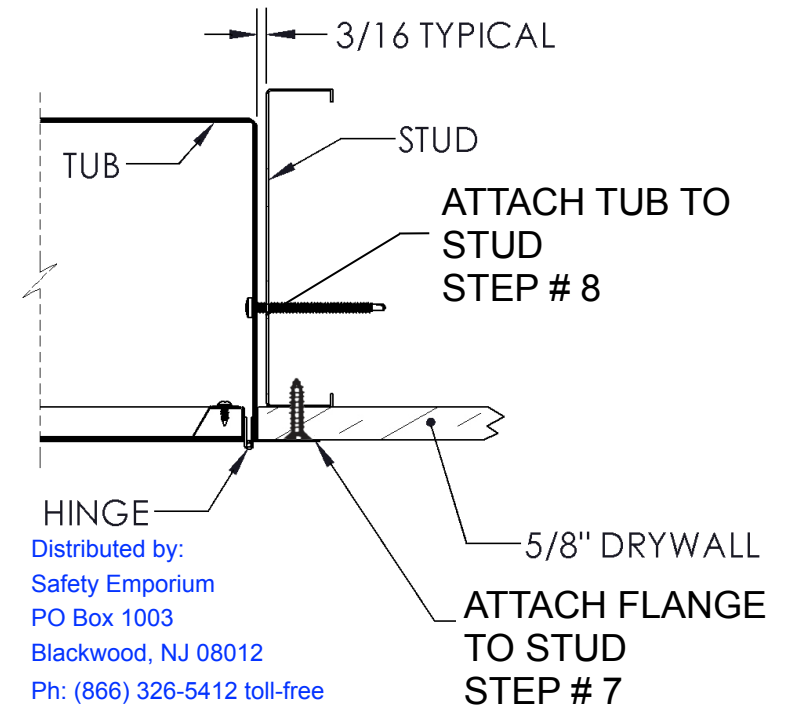

Distributed by:  
Safety Emporium  
PO Box 1003  
Blackwood, NJ 08012  
Ph: (866) 326-5412 toll-free  
Fax: (856) 553-6154  
[esupport@safetyemporium.com](mailto:esupport@safetyemporium.com)  
[www.safetyemporium.com](http://www.safetyemporium.com)

**We Recommend Attaching the Drywall Flange  
to the Face of the Wall  
Before Attaching Tub to the  
Stud for this Model**



**ACTIVAR** INC.  
CONSTRUCTION PRODUCTS GROUP

© Activar Construction Products Group, Inc 2016  
SAF-T-LOK™ IS A TRADEMARK OF ACTIVAR, INC.

**PLEASE NOTE THIS IS A NEW CABINET DESIGN!!**

**SEE PAGE 2 FOR PLASTER INSTRUCTIONS**  
**IF YOUR CABINET DOES NOT HAVE A FLANGE, SEE "OLD" TRIMLESS INSTALLATION INSTRUCTIONS ONLINE**

**HEADQUARTERS & CUSTOMER SERVICE:** 9702 NEWTON AV S, BLOOMINGTON, MN 55431 **PH:** 800-554-6077 **FAX:** 952-835-2218 **EMAIL:** [SALES@ACTIVARCPG.COM](mailto:SALES@ACTIVARCPG.COM) [WWW.ACTIVARCPG.COM](http://WWW.ACTIVARCPG.COM)  
**ACPG WEST COAST/SAMSON:** COMMERCE, CA **WAREHOUSES:** DALLAS TX, FORT MYERS FL, LANCASTER PA, ATLANTA GA, CHICAGO, IL, SEATTLE WA, OMAHA NE, FARGO ND 03/28/2016

## INSTALLATION INSTRUCTIONS FOR PLASTER/STUCCO WALLS: TRIMLESS CABINETS

1. **NOTE these trimless cabinets are designed to be installed in plaster/stucco wall conditions prior to the application of lath and plaster/stucco.**
2. Remove all hardware and glazing, unlock cabinet if lock provided.
3. Install a framed opening above, below and at both sides of cabinet opening at specified location. Wall opening width, height and depth must correspond with dimensions indicated in catalog or detail and submittal sheet.
4. Use holes provided in cabinet tub for attaching to stud or substrate material. If wall configuration does not allow for that, then follow step 5 below; otherwise, skip to step 6.
5. [Drilling Additional Holes in Tub] Drill (2) 1/8" (3.2 mm) holes through tub on each side of cabinet.
6. *Valve & Hose Cabinets Only:* Select knockout location that supply pipe will enter the cabinet through. Remove knockout tab at that location and install collar. Mark location on wall and studs. Plumb to the cabinet.
7. Place cabinet in position so that the plaster flange rests flush on the substrate. Secure the face of the flange to the substrate using screws.
8. Attach the tub to the studs with Universal # 6 x 2-1/2" (6.4 cm) self-drilling screws. Be sure not to over-tighten on either side, which could pull the cabinet out of position in the opening and result in an exposed gap between the cabinet frame and wall opening.
9. Start the screw without completely tightening; then start a screw on the opposite side of the tub. One all screws are started, tighten each screw in a "criss-cross" pattern. A torque setting of 4-6 is recommended if using a screw gun.
10. Once screws are fully tightened, check cabinet for square and plumb. Adjust if necessary. All interior sides should be straight with no bowing or warping.
11. Check cabinet door assembly for freedom of movement. If it binds, shim as necessary to remove any racking of tub at attachments of stud. Cabinet will need to be removed temporarily in order to add shims.
12. Finish wall construction. Lay metal lath material over substrate and fasten securely. Ensure that lath extends over the wall flange at the perimeter of the cabinet.
13. Apply plaster and/or stucco over metal lath as per manufacturer's instructions and job specifications. Use the forward-projecting edge of the cabinet as a "plaster stop", for a smooth and flush final installation. Take care not to get plaster on the hinge barrel—remove with a soft rag if needed.
14. Remove protective plastic from acrylic or glass and install decal if intended for glass. (Panorama Models Glazing is Pre-Installed)
15. Align glazing on inside of door, holding in place while installing glass mounting clips on inside of door. Do not over-tighten.
16. Install handle and roller catch or SAF-T-LOK™ in door. Install alarm if provided.

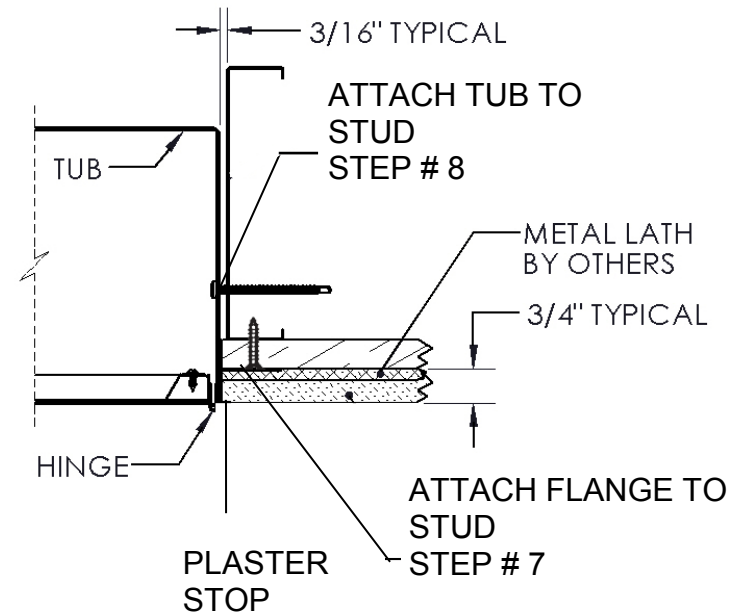

**We Recommend Attaching the Plaster Flange to the Face of the Wall Substrate Before Attaching Tub to the Stud for this Model**



**ACTIVAR** INC.  
CONSTRUCTION PRODUCTS GROUP

© Activar Construction Products Group, Inc 2016  
SAF-T-LOK™ IS A TRADEMARK OF ACTIVAR, INC.

**PLEASE NOTE THIS IS A NEW CABINET DESIGN!!**

**SEE PAGE 1 FOR DRYWALL INSTRUCTIONS**  
**IF YOUR CABINET DOES NOT HAVE A FLANGE, SEE "OLD" TRIMLESS INSTALLATION INSTRUCTIONS ONLINE**

**HEADQUARTERS & CUSTOMER SERVICE:** 9702 NEWTON AV S, BLOOMINGTON, MN 55431 **PH:** 800-554-6077 **FAX:** 952-835-2218 **EMAIL:** SALES@ACTIVARCPG.COM WWW.ACTIVARCPG.COM  
**ACPG WEST COAST/SAMSON:** COMMERCE, CA **WAREHOUSES:** DALLAS TX, FORT MYERS FL, LANCASTER PA, ATLANTA GA, CHICAGO, IL, SEATTLE WA, OMAHA NE, FARGO ND 03/28/2016